

MASHPEE WAMPANOAG TRIBE

Mobile Modular provided the Mashpee Wampanoag Tribe a temporary dental facility that can easily be relocated to a permanent location.

THE CHALLENGE

The Mashpee Wampanoag Tribe was in need of a dental facility to serve the tribe that could also be easily relocated to a permanent location in the future. The building needed to be close to the health administration and clinic buildings that our team had previously installed. Most importantly, the dental clinic had to accommodate the existing government-owned dental equipment the tribe had already purchased which was stored at a nearby warehouse waiting to be installed in the new facility. Additionally, new equipment had to be compatible with the previously purchased equipment.



Customer Name: Mashpee Wampanoag Tribe

Project Location: Mashpee, MA

Building Type(s): Modular Healthcare

Module Count: 2

Total Sq. Ft.: 2,100 sq. ft.

THE SOLUTION

Mobile Modular provided a 2,100 square foot three-chair dental facility for the Mashpee Wampanoag Tribe. Throughout the turn-key project, we served as the point of contact for the government from building design to project completion. The design build modular construction was closely managed by Mobile Modular who worked with the modular manufacturer to ensure accurate rough-in locations necessary for all dental equipment. This required our team to coordinate and conduct a thorough inventory of all previously purchased equipment and careful procurement of all remaining dental equipment to complete a functional and productive three-chair dental facility.

Contact Us Today!

866.889.7777 • mobilemodular.com



BUILDING LAYOUT

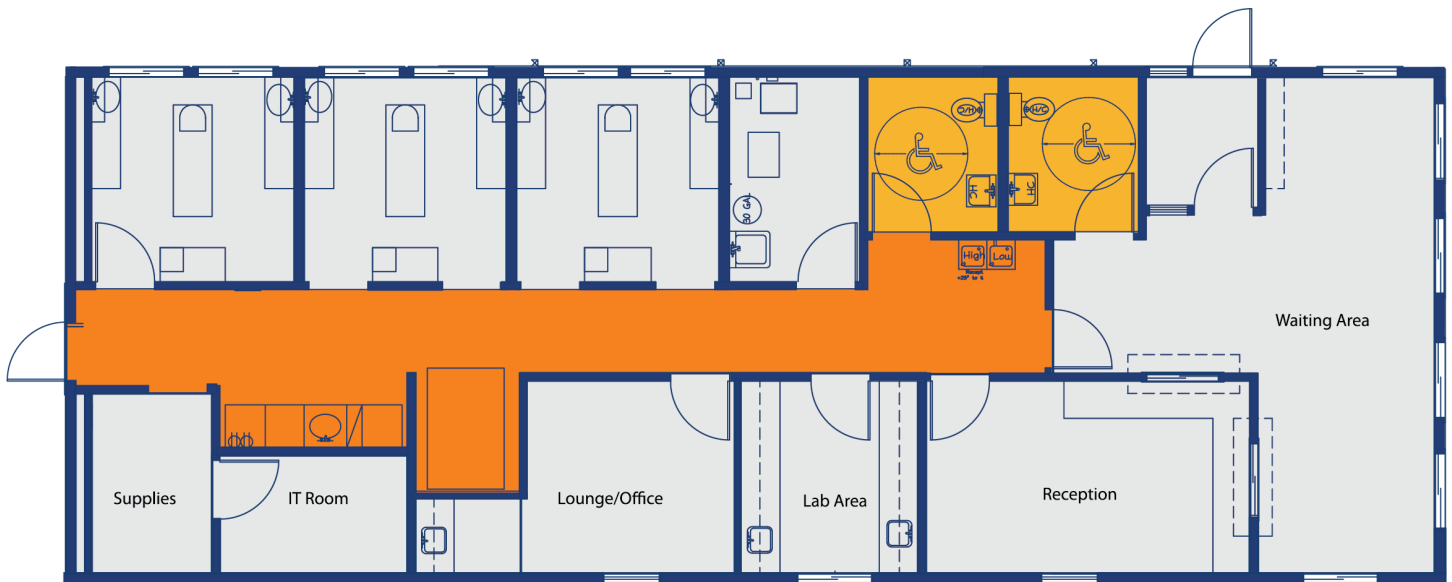

Contact Us Today!

866.889.7777 • mobilemodular.com

