

MOBILE MODULAR BUILDS NEW MODULAR COMPLEX FOR U.S. BUREAU OF RECLAMATION

A unique project supporting a vital organization

THE CHALLENGE

The Bureau of Reclamation, established in 1902 through the Reclamation Act, is crucial for managing water resources in arid U.S. states. This agency's efforts include constructing major structures like Hoover Dam and Shasta Dam, aiding the development of the West.

Covering two-thirds of California, the Klamath Basin, and most of Nevada, the California-Great Basin Region is one of five Reclamation regions. It oversees significant water projects such as the Central Valley Project, Oregon's Klamath Project, Nevada's Newlands, Humboldt, Washoe, and Truckee projects, and Central California's Cachuma, Orland, Santa Maria, Solano, and Ventura River projects.

THE SOLUTION

The 15,080-square-foot building, comprising 56 offices, serves as the headquarters for a diverse team of professionals supporting the Klamath Project, crucial for providing irrigation to the Klamath Basin, including the Tule Lake and Lower Klamath National Wildlife Refuges. Enhanced with a steep roof for snow management, the building also features security measures like bullet-proof windows and doors at the entrance.

Contact Us Today!

866.889.7777 • mobilemodular.com

Customer Name: U.S. Bureau of Reclamation

Project Location: Klamath Falls, Oregon

Building Type(s): 56 Modular Offices

Job Type: Custom Modular Solution

Total Sq. Ft: 15,080 sq. ft.

BUILDING FEATURES

- Size: 260' x 58'; 15,080 total sq. ft.
- Contract Value: 4.8MM
- 56 offices
- Bullet-proof doors and windows in foyer and entrance
- 1,056 sq ft conference room with operable doors to divide into 4 smaller conference rooms.
- Building height: 22' . Trusses are approximately 10' tall.
- Equipped with complete sprinkler system in attic and office space.
- Life and Safety Fire Alarm



BUILDING LAYOUT

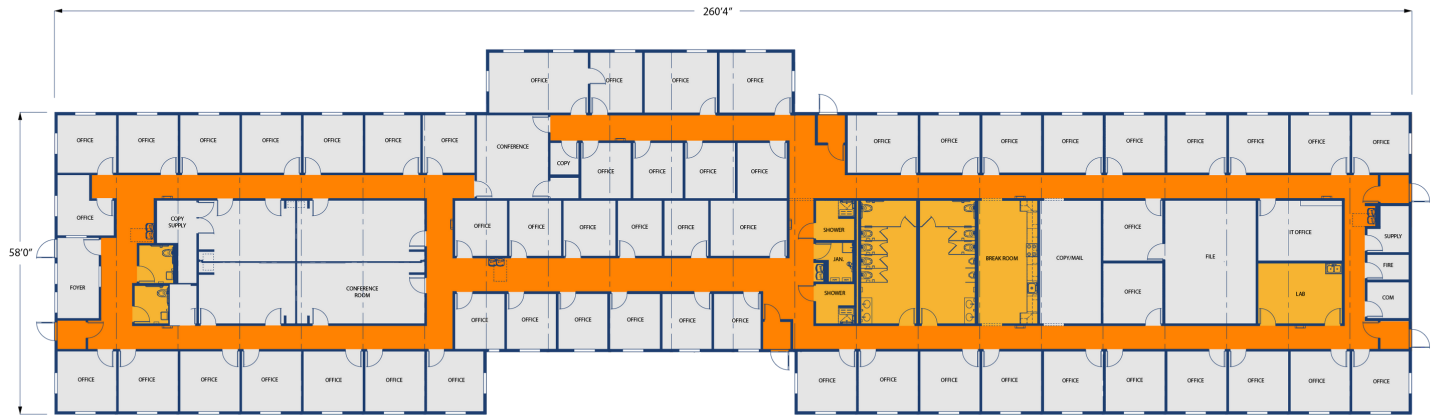

Contact Us Today!

866.889.7777 • mobilemodular.com

