

DA EVERETT CONSTRUCTION AND ELI LILLY PHARMACEUTICALS

DA Everett Construction and Eli Lilly Pharmaceuticals leveraged modular solutions to efficiently create temporary office spaces during construction.

THE CHALLENGE

The primary challenge was to provide over 6,400 square feet of temporary office space that was not only functional but also minimally invasive to the construction site's operations. Eli Lilly required these facilities to be fully operational, complete with furnishings and a self-contained sewer and water system, all within a tight time frame of under two months. The project demanded a solution that was quick to deploy, efficient, and capable of meeting the specific needs of a highly regulated pharmaceutical industry.



Customer Name: DA Everett Construction/ Eli Lilly Pharmaceuticals

Project Location: Concord, NC

Building Type(s): Office Buildings

Module Count: 9

Total Sq. Ft: 6,480 sq. ft.

THE SOLUTION

Mobile Modular, recognized for its expertise in delivering high-quality modular construction solutions, was the chosen supplier for this project. Understanding the unique requirements of Eli Lilly and DA Everett Construction, Mobile Modular provided two modular units measuring 36x60 (2,106 sq ft) and 72x60 (4,320 sq ft), respectively. These units were designed to offer a combined total of over 6,400 square feet of brand-new, fully furnished operational space.

The modular offices were equipped with all necessary amenities, including multiple powered cubicles and furnished breakout offices to accommodate an entire integration team. This approach not only met Eli Lilly's needs for temporary office space but also exemplified Mobile Modular's ability to deliver custom solutions swiftly and efficiently, with minimal impact on the surrounding construction activities.

Contact Us Today!

866.889.7777 • mobilemodular.com



BUILDING LAYOUT

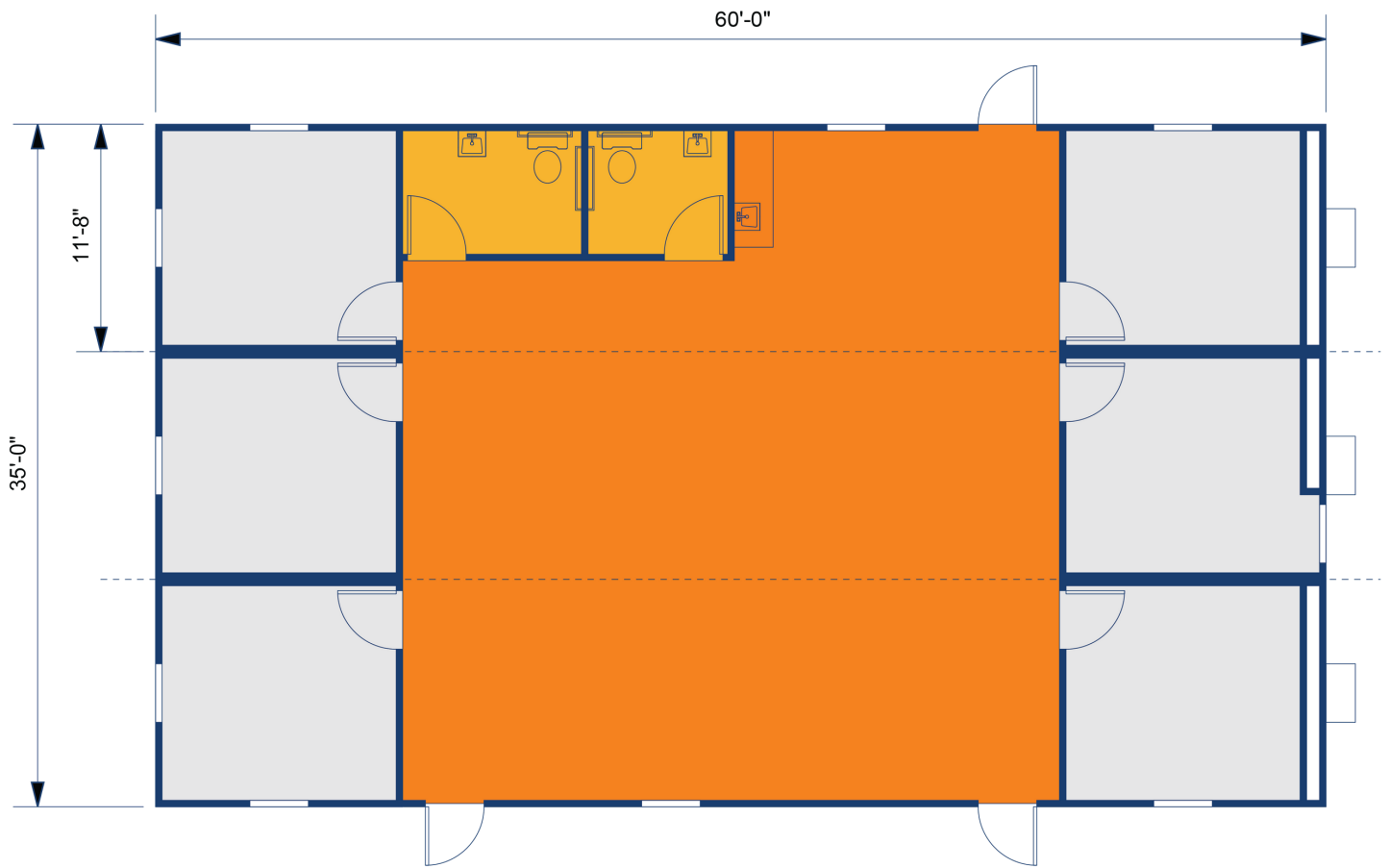

Contact Us Today!

866.889.7777 • mobilemodular.com

